

ITEM NO.	PART NUMBER	DESCRIPTION	Vendor	QTY.
1	15-FAB-9802-005	ODU STAND	-	1
2	GSK113	RUBBER ISOLATION GASKET	-	2
3	INSTALLER PROVIDED	M10 HEX HEAD CAP SCREW, 316 SS (A4)	INSTALLER PROVIDED	4
4	94709A418	3/8" NEOPRENE BONDED WASHER, 18-8 SS (A2)	MCMASTER-CARR	12
5	INSTALLER PROVIDED	M10 JAM NUT 316 SS (A4)	INSTALLER PROVIDED	4
6	INSTALLER PROVIDED	M10 HEX NUT 316 SS (A4)	INSTALLER PROVIDED	4
7		TYPICAL SHIP-SIDE MOUNT	-	-
8	78119	7/16" INTERNAL TOOTH LOCK WASHER, 316 SS (A4)	FASTENAL	6
9	93635A424	M10-1.5X30MM HEX HEAD CAP SCREW, 316 SS (A4)	MCMASTER-CARR	4
10	93635A416	M10-1.5X20MM HEX HEAD CAP SCREW 316 SS (A4)	MCMASTER-CARR	1
11	HST100	RADOME ASSEMBLY	-	1
12	C5-A	LOCTITE C5-A COPPER ANTI-SEIZE LUBRICANT	LOCTITE	1
13	MW6400000A40000	M10 FLAT WASHER, 316 SS (A4)	FASTENAL	1

ANY BOM SUBSTITUTIONS TO BE APPROVED BY Iridium

INSTALLATION INSTRUCTIONS:

- RECOMMENDED STAND MOUNTING**
NOTE: SHIP-SIDE MOUNT MAY DIFFER FROM THE EXAMPLE SHOWN. NEOPRENE BONDED STAINLESS STEEL WASHERS ARE INCLUDED TO PROTECT THE ANTI-CORROSION COATING ON THE STAND AND TO PREVENT GALVANIC CORROSION OF THE ASSEMBLY. 316 STAINLESS STEEL HARDWARE IS RECOMMENDED FOR INSTALLATION.
TAKE CARE WHEN TRANSPORTING THE RADOME (1) AND STAND (2) SO AS NOT TO DAMAGE THE CORROSION RESISTANT COATINGS.
- PLACE AN ISOLATION GASKET (3) ONTO THE SHIP'S MOUNTING POST (8).
- PLACE THE STAND (2) ONTO THE ISOLATION GASKET, WITH THE SLOTTED SIDE FACING DOWN.
- SLIDE A NEOPRENE BONDED ISOLATION WASHER (5) ONTO AN M10 HEX HEAD BOLT (4), WITH ITS METAL SIDE CONTACTING THE BOLT.
- SLIDE THIS BOLT ASSEMBLY THROUGH THE SLOT IN THE STAND THEN THROUGH THE HOLE IN THE SHIP'S MOUNTING POST.
- SLIDE ON ANOTHER ISOLATION WASHER WITH THE RUBBER SIDE FACING THE MOUNTING POST.
- THREAD ON A JAM NUT (6) FINGER TIGHT.
- REPEAT STEPS 4-8 FOR THE REMAINING THREE BOLTS.
- TIGHTEN THE JAM NUTS USING 10-12 FT-LBS OF TORQUE.
- FOR ALL FOUR BOLTS: PREVENTING THE JAM NUT AND BOLT FROM TURNING, TIGHTEN THE HEX NUT AGAINST THE JAM NUT UNTIL THEY LOCK, TAKING CARE NOT TO OVERTIGHTEN.
- RADOME MOUNTING**
NOTE: GROUNDING LUG ON RADOME BASE MUST BE FACING STERN. ALIGN SHIP-SIDE MOUNT ACCORDING TO THE DIAGRAM BELOW THESE INSTRUCTIONS.
- PLACE AN ISOLATION GASKET (3) ON TOP OF THE STAND.
- ROUTE THE POWER/DATA CABLE (NOT PICTURED) THROUGH EITHER THE BOTTOM OF THE STAND OR THROUGH ITS SIDE HOLE UP THROUGH THE TOP HOLE IN THE STAND. PLUG THE CABLE INTO THE CONNECTOR ON THE BOTTOM OF THE RADOME.
- PLACE THE RADOME ONTO THE STAND, WITH THE ARROW ON THE BASE POINTING TOWARD THE BOW. SLIDE A LOCK WASHER (9) THEN AN ISOLATION WASHER (5) ONTO AN M10X30mm HEX HEAD BOLT (10).
- THE METAL SIDE OF THE ISOLATION WASHER SHOULD FACE THE LOCK WASHER. APPLY ANTI-SEIZE COMPOUND (12, NOT PICTURED) TO THE BOLT THREADS.
- SLIDE THE PREPARED BOLT UP THROUGH THE STAND, AND FINGER TIGHTEN INTO THE DOME ARRAY.
- REPEAT STEPS 12 AND 14 FOR THE REMAINING THREE BOLTS.
- TIGHTEN THE FOUR BOLTS USING 10-12 FT-LBS OF TORQUE.
- ATTACH GROUND CABLE BETWEEN TWO LOCK WASHERS (9) ON THE 20mm M10 BOLT (11). PLACE FLAT WASHER (13) BETWEEN THE RADOME BASE AND LOCK WASHER AND TIGHTEN INTO GROUND POST USING 10-12 FT-LBS OF TORQUE.

REV.	DESCRIPTION	ENGR.	DATE
A	INITIAL CONTROLLED DRAWING	N.MAHER	1/16/2012
C	ADDED TORQUE SPEC TO INSTRUCTIONS	N.MAHER	4/3/2012
C	1. WASHER ADDED 2. BOM DESCRIPTIONS UPDATED 3. ITEM B CHANGED TO 7/16" 316SS	C.LAIDLAW	12/14/2012

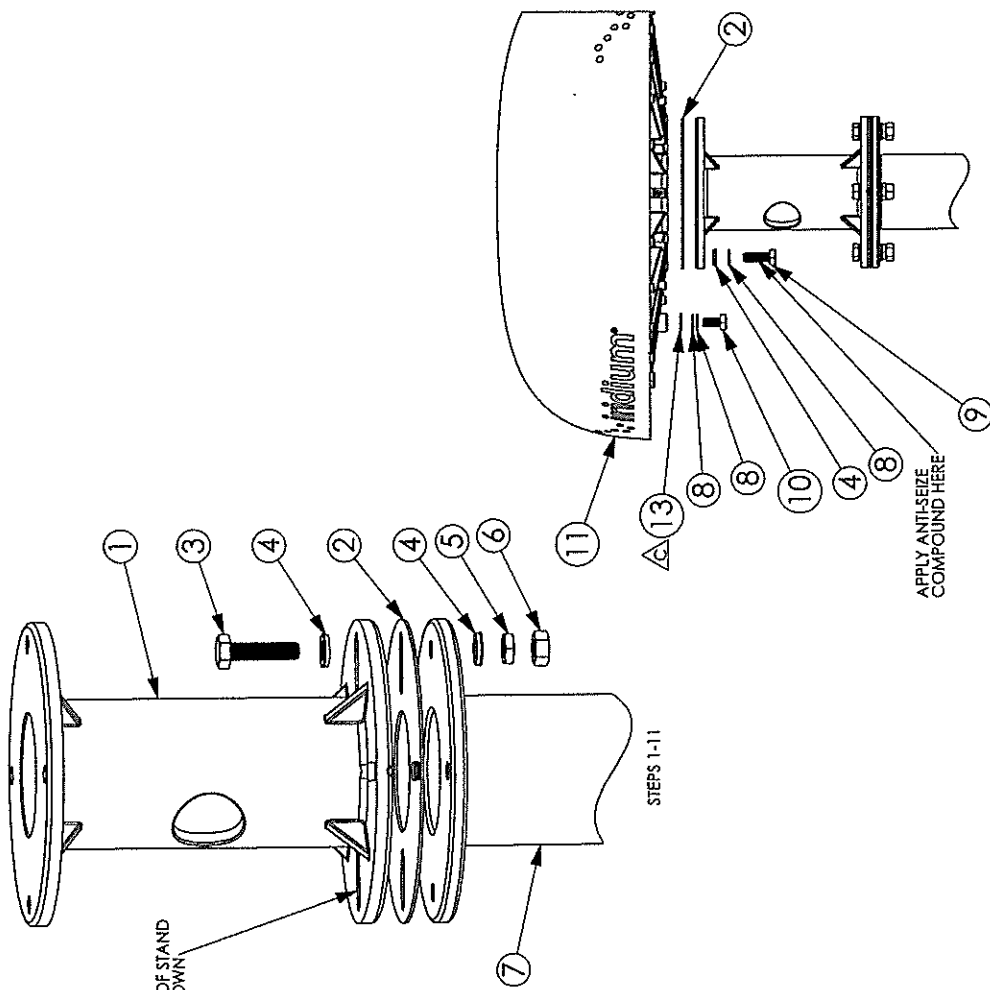

APPLY ANTI-SEIZE COMPOUND HERE

STEPS 12-19

DESCRIPTION		PILOT - SHIP MOUNT INSTRUCTIONS	
iridium		DOCUMENT NUMBER	DRAWN BY
PROPERTY OF Iridium LLC. THIS DRAWING IS THE PROPERTY OF Iridium LLC. ALL RIGHTS ARE RESERVED. NO PART OF THIS DRAWING IS TO BE REPRODUCED OR TRANSMITTED IN ANY FORM OR BY ANY MEANS, ELECTRONIC OR MECHANICAL, INCLUDING PHOTOCOPYING, RECORDING, OR BY ANY INFORMATION STORAGE AND RETRIEVAL SYSTEM, WITHOUT THE WRITTEN PERMISSION OF Iridium LLC.		D-ADA101-C	N.MAHER
MATERIAL		DATE	DATE
THIRD ANGLE PROJECTION		1/16/2012	1/16/2012
OTHERWISE SPECIFIED		SCALE	SCALE
LINEAR DIMENSIONS		1:0.15	1:0.15
ANGULAR DIMENSIONS		± 2°	± 2°
HOLE TO HOLE		± 0.10	± 0.10
		REVISION	REVISION
		C	C
		1	1